

0F3CR540E110000

SLIPPER CLUTCH KIT FOR SUZUKI RM-Z 450

ASSEMBLY INSTRUCTIONS

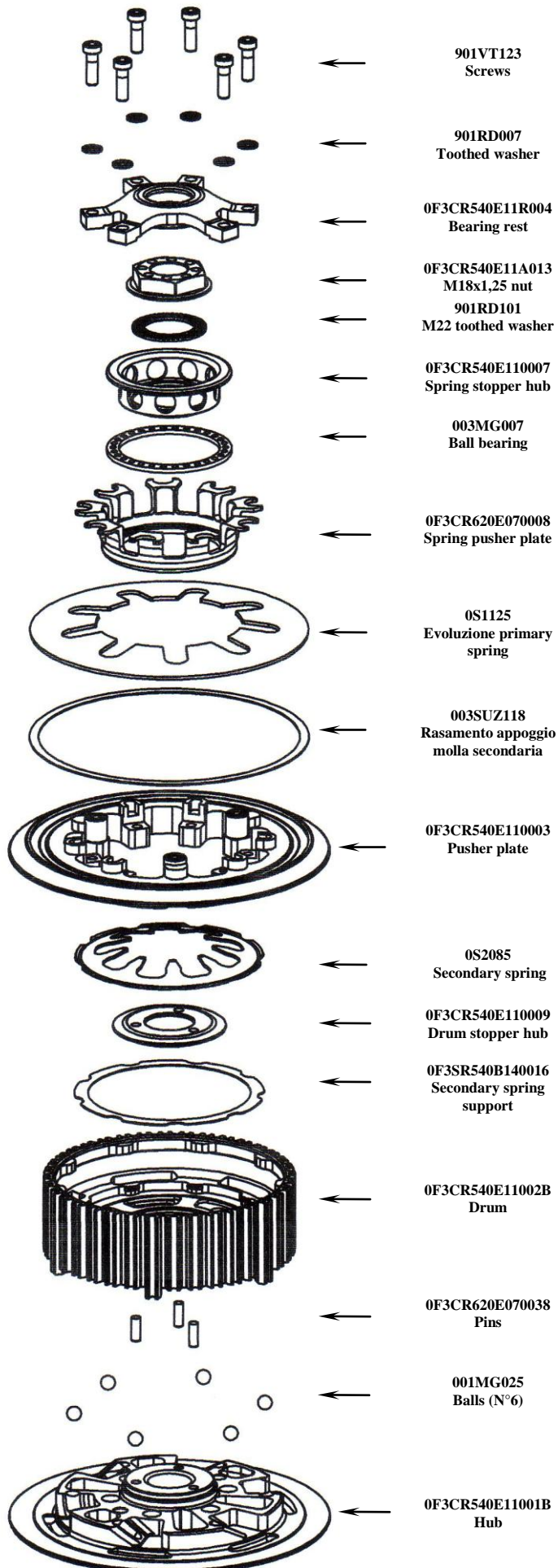

- Pre-assemble the hub pack: put the 6 steel balls (001MG025) at the bottom of the grooves onto the hub (0F3CR540E07001B) using a little bit of grease. Fix the clutch drum (0F3CR540E07002B) on the clutch hub (0F3CR620E07001C) at rest position using an ordinary screw.
- Insert the hub pack onto the main shaft.
- Replace the original clutch plates. NOTE: DO NOT insert the two rings (one flat and one concave) to be found in the original disc pack. The total thickness of the plates should be 36,2 mm.
- Remove the ordinary screw from the hub.
- Insert the drum stopper hub (0F3CR540E110009) into the hub housing (0F3CR540E11001B) taking care the three pins (0F3CR620E070038) inside the hub (0F3CR540C11001B) place themselves in the three holes present on the drum stopper hub (0F3CR540E110009) and they are on a level with the superior surface of the drum stopper hub.
- Verify that the secondary spring support (0F3SR540B140016) is well inserted into its own housing inside the drum (0F3CR540E11002B).
- Insert the secondary spring (0S2085) in its seat into the drum (0F3CR540E11002B) with some grease.
- Insert the pusher plate (0F3CR540E110003) into the seats on the drum (0F3CR540E11002B).
- Verify that the primary spring support (003SUZ118) is well inserted in its own housing inside the pressure plate (0F3CR540E110003).
- Insert the Evoluzione Racing spring (0S1125) into the pressure plate (0F3CR540E110003).
- Insert in sequence into Evoluzione spring (0S1125): the pusher spring plate (0F3CR540E110008) with the shaped part facing up as shown in the picture, the ball bearing (003MG007) and the spring stopper hub (0F3CR540E110007), the toothed washer (901RD101) with the convex side facing up, and finally the nut (0F3CR540E11A013). Line up the legs of the pusher spring plate (0F3CR540E110008) with the spring legs (0S1125).
- Then tighten the nut on the drive shaft using the dynamometric tool to the torque suggested by the manufacturer. Use the specific tool 002AMS001 (which is not in the package) to hold pusher plate (0F3CR540E110003).
- Position the bearing rest (0F3CR540E11R004) into the relevant housing of the pressure plate (0F3CR540E110003) taking care to correctly align with the rod and fix it with the six screws (901VT123) with the self locking washers.

NB: once completed assembly, operate again and again the clutch lever, check that pusher plate performs opening and closing movements correctly. The nut (0F3CR540E11A013) is designed to give additional self locking effect. This effect could be reduced in case of frequent un-installations: in case of need substitute it with the second nut (0F3CR540E11A013) provided as a spare part.

NORME DI SICUREZZA GENERALI

- IL PRESENTE FOGLIO CONTIENE LE ISTRUZIONI PER ESEGUIRE CORRETTAMENTE LE PRINCIPALI OPERAZIONI DI INSTALLAZIONE DELLA FRIZIONE.
- LA STM. SI RISERVA IL DIRITTO DI APPORTARE MODIFICHE IN QUALSIASI MOMENTO AL PRODOTTO SENZA ALCUN OBBLIGO DI AGGIORNAMENTO.
- LE OPERAZIONI DI MONTAGGIO DEVONO ESSERE SCRUPOLOSAMENTE OSSERVATE ED ESEGUITI ESCLUSIVAMENTE DA UN TECNICO SPECIALIZZATO.
- PRIMA DI INSTALLARE LA FRIZIONE ESEGUIRE UN CONTROLLO PER VERIFICARE L'EVENTUALE PRESENZA DI GUASTI O ANOMALIE SUL VEICOLO
- ACCERTARSI CHE NON CI SIANO PARTI MANCANTI O DANNEGGIATE NELLA CONFEZIONE.
- ALCUNE PARTI DELLA FRIZIONE E DEI SUOI COMPONENTI POSSONO PRESENTARE SUPERFICI TAGLIANTI : MANEGGIARE CON ATTENZIONE.
- ALCUNI COMPONENTI DELLA FRIZIONE PER LE LORO PICCOLE DIMENSIONI POTREBBERO ESSERE INGERITI : TENERE LONTANO DALLA PORTATA DEI BAMBINI

