

# 0A5MR620H110000

## EVOLUZIONE SLIPPER CLUTCH FOR YAMAHA YZ426F & WR426F

### ASSEMBLY INSTRUCTIONS

0A5MR620B110000  
Nut tool

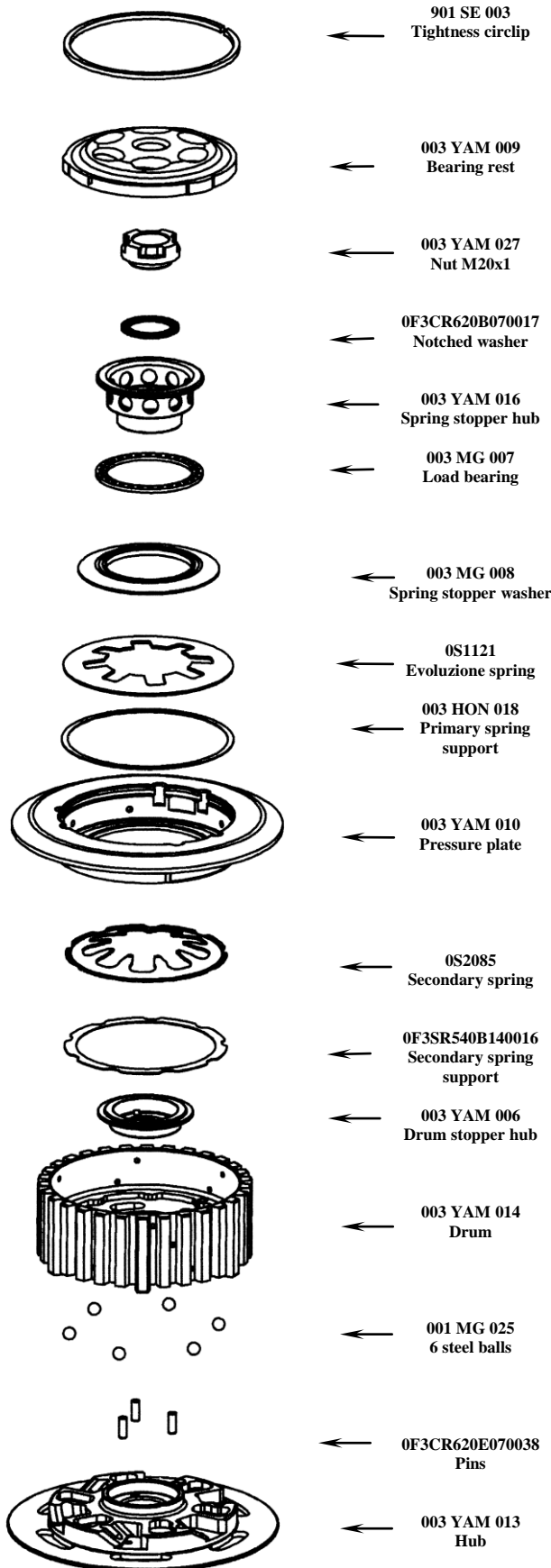

- Pre-assemble the hub pack: place at the bottom of the grooves the 6 steel balls (001MG025) onto the hub (003YAM013) using a small amount of grease. With an M6 screw fix the clutch drum (003YAM014) onto the clutch hub (003YAM013) in an at-rest position.
- Insert the hub pack onto the main shaft.
- Insert the drum stopper hub (003YAM006) into the hub (003YAM013) housing taking care that the three pins (0F3CR620E070038) inside the hub (003YAM013) place themselves in the three holes present on the drum stopper hub (003YAM006).
- Reinstall the plates of the original clutch, making sure that the total thickness of the disc pack is 36.5 mm  $\pm$  0.2.
- Remove the M6 screw from the hub.
- Verify that the secondary spring support (0F3SR540B140016) is well inserted into its own housing inside the drum (003YAM014).
- Insert the secondary spring (0S2085) in its seat into the drum (003YAM014).
- Mount the pressure plate (003YAM010) onto the drum (003YAM014).
- Insert the Evoluzione spring (0S1121) into the pressure plate with the convex part facing up (STM logo facing up) making sure that the spring support is well placed into the pressure plate itself.
- Assemble the complete spring stopper group starting from the spring stopper washer (003MG008) with the shaped part facing up as illustrated. Insert the load bearing (003MG007) and finally the spring stopper hub (003YAM016).
- Insert the spring stopper hub group inside the Evoluzione spring (0S1121) verifying that the secondary spring remains in its seat.
- Insert the notched washer ((0F3CR620B070017) in the relevant opening placed on the upper part of the hub (003YAM016) with the convex part facing up, then insert and screw the nut (003YAM027). Lock with the dynamometric key to the torque suggested by the manufacturer using the tool (0A5MR620B110000) included in the package.
- Reinstall the clutch pusher on the drive shaft.
- Mount the bearing rest (003YAM009) onto the bearing and push it into pressure plate (003YAM010) housing, being careful to correctly fit it into the grooves.
- Manually exert pressure on the bearing rest (003YAM009) in order to release the seat for the tightness circlip (901SE003). If necessary screw the clutch lever perch adjustment in order to push the bearing rest (003YAM009) into its seat.
- Insert the tightness circlip (901SE003) in the pressure plate seat.
- Make sure that the circlip adheres to the full perimeter of the opening itself.

**NB: once the assembly is completed, repeatedly operate the clutch lever to check that pressure plate correctly performs the opening and closing movements.**

#### GENERAL SAFETY REGULATIONS

- IN THIS SHEET ARE REPORTED THE DIRECTIONS TO PERFORM CORRECTLY THE CLUTCH ASSEMBLY OPERATIONS.
- STM RESERVES THE RIGHT, WITHOUT NOTICE, TO INTRODUCE ANY TECHNICAL CHANGE WHENEVER DEEMED IT TO BE NECESSARY TO IMPROVE FUNCTION AND QUALITY OF THE PRODUCTS.
- ASSEMBLY OPERATIONS MUST BE PERFORMED BY A SKILLED TECHNICIAN AND MUST BE SCRUPULOUSLY OBSERVED.
- BEFORE MOUNTING THE CLUTCH MAKE A COMPLETE INSPECTION OF THE MOTORBIKE COMPONENTS, IN ORDER TO VERIFY THE POSSIBLE PRESENCE OF FAULTS OR ANOMALIES ON THE VEHICLE.
- MAKE SURE THAT THERE ARE NO MISSING/DAMAGED PARTS IN THE CLUTCH KIT.
- SOME PARTS OF THE CLUTCH AND ITS COMPONENTS CAN HAVE SHARP SURFACE: HANDLE WITH CARE.
- SOME COMPONENTS OF THE CLUTCH, BECAUSE OF THEIR SMALL DIMENSIONS CAN BE SWALLOWED: KEEP AWAY FROM CHILDREN.

