

003YAM001

EVOLUZIONE SLIPPER CLUTCH FOR YAMAHA YZ450F & WR450F

ASSEMBLY INSTRUCTIONS

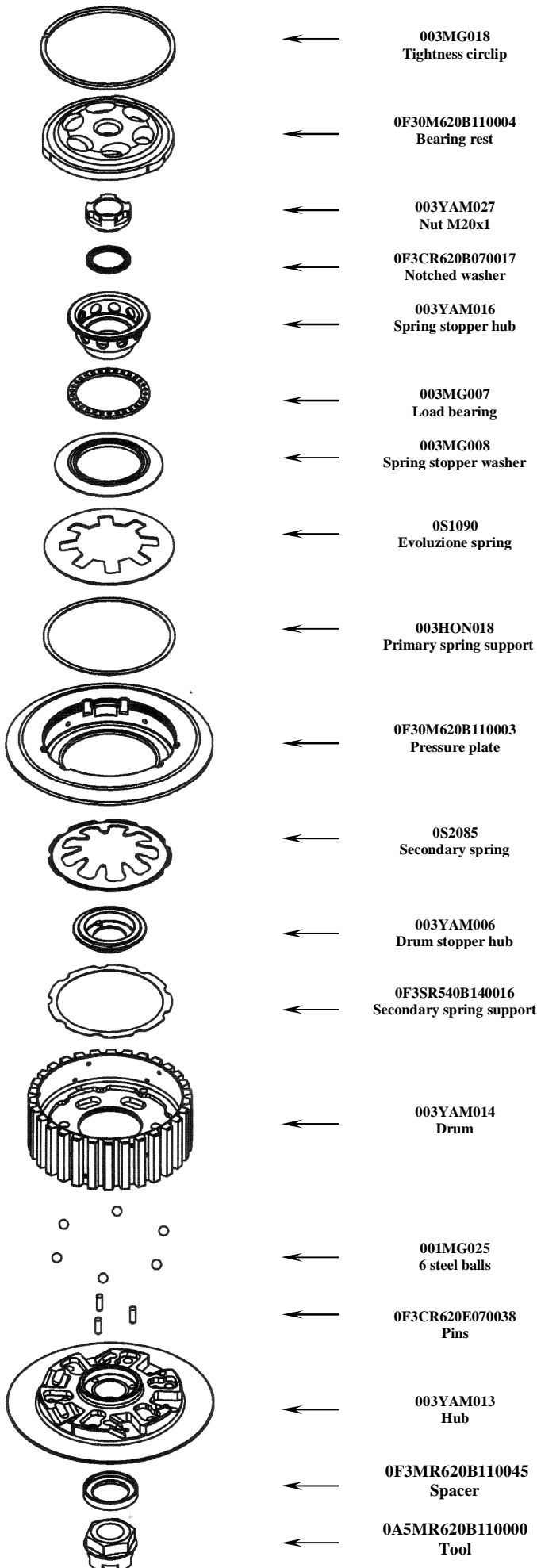

- Insert the spacer (0F3MR620B110045) in the clutch shaft.
- Pre-assemble the hub pack: place at the bottom of the grooves the 6 steel balls (001MG025) onto the hub (003YAM013) using a small amount of grease. With an M6 screw fix the clutch drum (003YAM014) onto the clutch hub (003YAM013) in an at-rest position.
- Insert the hub pack onto the main shaft.
- Insert the drum stopper hub (003YAM006) into the hub (003YAM013) housing taking care that the three pins (0F3CR620E070038) inside the hub (003YAM013) place themselves in the three holes present on the drum stopper hub (003YAM006).
- Reinstall the plates of the original clutch, making sure that the total thickness of the disc pack is 36.5 mm \pm 0.2.
- Remove the M6 screw from the hub.
- Verify that the secondary spring support (0F3SR540B140016) is well inserted into its own housing inside the drum (003YAM014).
- Insert the secondary spring (0S2085) in its seat into the drum (003YAM014).
- Mount the pressure plate (0F30M620B110003) onto the drum (003YAM014).
- Insert the Evoluzione spring (0S1090) into the pressure plate with the convex part facing up (STM logo facing up) making sure that the spring support is well placed into the pressure plate itself.
- Assemble the complete spring stopper group starting from the spring stopper washer (003MG008) with the shaped part facing up as illustrated. Insert the load bearing (003MG007) and finally the spring stopper hub (003YAM016).
- Insert the spring stopper hub group inside the Evoluzione spring (0S1090) verifying that the secondary spring remains in its seat.
- Insert the notched washer ((0F3CR620B070017) in the relevant opening placed on the upper part of the hub (003YAM016) with the convex part facing up, then insert and screw the nut (003YAM027). Lock with the dynamometric key to the torque suggested by the manufacturer using the tool (0A5MR620B110000) included in the package.
- Reinstall the clutch pusher on the drive shaft.
- Mount the bearing rest (0F30M620B110004) onto the bearing and push it into pressure plate (0F30R620B110003) housing, being careful to correctly fit it into the grooves.
- Manually exert pressure on the bearing rest (0F30M620B110004) in order to release the seat for the tightness circlip (003MG018). If necessary screw the clutch lever perch adjustment in order to push the bearing rest (0F30M620B110004) into its seat.
- Insert the tightness circlip (003MG018) in the pressure plate seat.
- Make sure that the circlip adheres to the full perimeter of the opening itself.

NB: once the assembly is completed, repeatedly operate the clutch lever to check that pressure plate correctly performs

GENERAL SAFETY REGULATIONS

THIS SHEET REPORTS THE INSTRUCTIONS TO CORRECTLY PERFORM THE MAIN CLUTCH ASSEMBLY PROCEDURES
STM RESERVES THE RIGHT TO MODIFY THE PRODUCT AT ANY TIME AND WITHOUT NOTIFICATION
THE ASSEMBLY OPERATIONS MUST BE SCRUPULOUSLY OBSERVED AND CARRIED OUT BY A SKILLED TECHNICIAN
BEFORE INSTALLING THE CLUTCH AN INSPECTION MUST BE CARRIED OUT TO VERIFY THE PRESENCE OF DEFAULTS OR ANOMALIES OF THE VEHICLE
MAKE SURE THAT THERE ARE NO MISSING OR DAMAGED PARTS IN THE PACKAGE
SOME PARTS OF THE CLUTCH OR OF THE CLUTCH COMPONENTS CAN PRESENT A SHARP SURFACE: PLEASE HANDLE WITH CARE
SOME CLUTCH COMPONENTS ARE SMALL AND COULD BE SWALLOWED: KEEP AWAY FROM CHILDREN



STM S.r.l.

Via Campo Archemo, 20 - 10023 Chieri (TO)
Tel +39 011 9422832 Fax +39 011 9471447
Internet: www.stm.to.it E-mail: info@stm.to.it