

0F3MR570A110000

FTM-M010

EVOLUZIONE CLUTCH

KIT FOR TM 450/530

ASSEMBLY DIRECTIONS

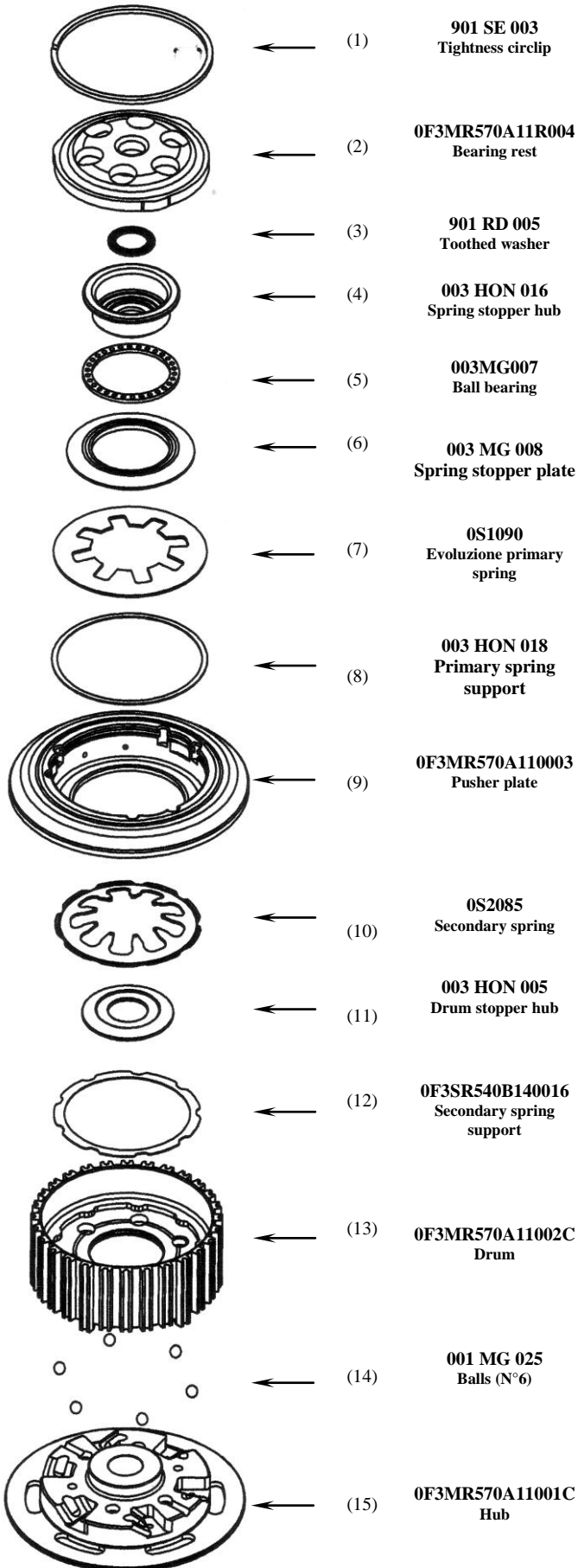

Perform the assembly starting from the hub pack: put the 6 steel balls (14) at the bottom of grooves using a little amount of grease. Fix the clutch drum (13) on the clutch hub (15) at rest position using an ordinary screw.

Insert the hub pack on gear shaft.

Insert the drum stopper control plate (11) into the hub seat (15). Reinstall original clutch plates (according to thickness suggested by manufacturer).

The plates pack must be high 35 mm \pm 03mm.

ATTENTION: remove the ordinary screw from the hub

Insert the secondary spring support thickness (12) and the secondary spring (10) into its seat with grooves, into the drum (13).

Mount pusher plate (9).

Put EVOLUZIONE spring (7) with the convex side facing up (STM logo facing up)

Assemble the complete spring stopper pack, starting from the washer (6) with the shaped part facing up as shown in the picture.

Insert the ball bearing (5) and the spring stopper hub (4).

Once completed these operations, put spring stopper pack on EVOLUZIONE spring (7).

Insert dished spring washer (3) with the convex side facing up, than insert and screw the original nut, tighten using the dynamometric tool to the torque suggested by the manufacturer. Use the specific tool in order to hold pusher plate (9) while tightening.

Mount bearing rest on the original clutch bearing and push it into pusher plate (9) seat, be careful to fit it correctly into related grooves.

ATTENTION: press by hand the bearing rest (2) in order to release the seat for the bearing rest circlip (1).

Fit by hand the above mentioned circlip (1) making sure that it is adherent to grooves perimeter.

NB: Once completed the assembly, pull and release the clutch lever, checking that pusher plate performs opening and closing movements correctly.

GENERAL SAFETY REGULATIONS

- IN THIS SHEET ARE REPORTED THE DIRECTIONS TO PERFORM CORRECTLY THE CLUTCH ASSEMBLY OPERATIONS.
- STM RESERVES THE RIGHT, WITHOUT NOTICE, TO INTRODUCE ANY TECHNICAL CHANGE WHENEVER DEEMED IT TO BE NECESSARY TO IMPROVE FUNCTION AND QUALITY OF THE PRODUCTS.
- ASSEMBLY OPERATIONS MUST BE PERFORMED BY A SKILLED TECHNICIAN AND MUST BE SCRUPULOUSLY OBSERVED.
- BEFORE MOUNTING THE CLUTCH MAKE A COMPLETE INSPECTION OF THE MOTORBIKE COMPONENTS, IN ORDER TO VERIFY THE POSSIBLE PRESENCE OF FAULTS OR ANOMALIES ON THE VEHICLE.
- MAKE SURE THAT THERE ARE NO MISSING/DAMAGED PARTS IN THE CLUTCH KIT.
- SOME PARTS OF THE CLUTCH AND ITS COMPONENTS CAN HAVE SHARP SURFACE: HANDLE WITH CARE.
- SOME COMPONENTS OF THE CLUTCH, BECAUSE OF THEIR SMALL DIMENSIONS CAN BE SWALLOWED: KEEP AWAY FROM CHILDREN.

