

003 SUZ 101

FSU-S070

CLUTCH KIT EVOLUZIONE SUZUKI GSXR 1000 2001 - 2004

ASSEMBLY INSTRUCTIONS

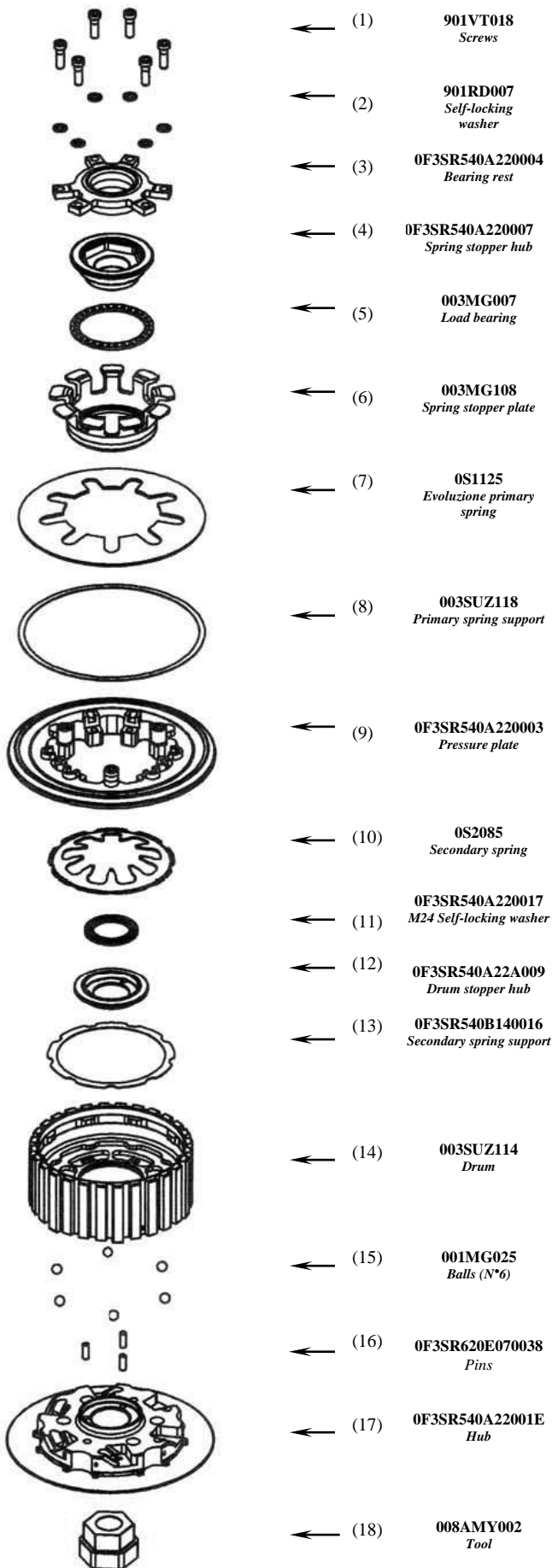

Put the 6 steel balls (15) at the bottom of the grooves using some grease and fix the drum (14) on the hub (17) in an at-rest position using an M6x1 screw.

Insert the hub pack on the primary shaft.

Insert the clutch plates. The disc pack total thickness must be 48.5 mm.

WARNING: should there be two rings in the original clutch disc pack, do NOT insert them back.

Remove the screw from the hub.

Place the drum stopper hub (12) in its seat making sure that the holes are aligned with the pins (16) present on the hub (17).

Insert the secondary spring support (13) into the drum (14) then place the secondary spring (10) in its seat in the drum (14) using a small amount of grease.

Insert the pressure plate (9) in its seat in the drum (14). Insert the primary spring (7) in the pressure plate (9).

Apply a thin coat of medium density threadlock on the shaft. Insert on the shaft the spring stopper plate (6), the load bearing (5), the self-locking washer (11) and the spring stopper hub (4).

Lock the spring stopper hub (4) with the STM tool (18) included in the package. Lock with the dynamometric key to the torque suggested by the manufacturer.

Assemble the complete bearing rest: mount the load bearing (3) and the bearing pin holder (from the original clutch) fitting the whole pack in the bearing rest (3) seat.

Place the complete bearing rest (3) in the pressure plate (9) seat, being careful to correctly fit it in the respective grooves. Fix it with the six screws (1) and washers (2). Minor adjustments at the lever could be necessary.

Place the complete bearing rest (3) in the pressure plate (9) seat, being careful to correctly fit it in the respective grooves. Fix it with the six screws (1) and washers (2). Minor adjustments at the lever could be necessary.

Place the complete bearing rest (3) in the pressure plate (9) seat, being careful to correctly fit it in the respective grooves. Fix it with the six screws (1) and washers (2). Minor adjustments at the lever could be necessary.

WARNING: once the assembly is completed, repeatedly operate the clutch lever to check that the pressure plate correctly performs the opening and closing movements.

GENERAL SAFETY REGULATIONS

- IN THIS SHEET ARE REPORTED THE DIRECTIONS TO PERFORM CORRECTLY THE CLUTCH ASSEMBLY OPERATIONS.
- STM RESERVES THE RIGHT, WITHOUT NOTICE, TO INTRODUCE ANY TECHNICAL CHANGE WHENEVER DEEMED IT TO BE NECESSARY TO IMPROVE FUNCTION AND QUALITY OF THE PRODUCTS.
- ASSEMBLY OPERATIONS MUST BE PERFORMED BY A SKILLED TECHNICIAN AND MUST BE SCRUPULOUSLY OBSERVED.
- BEFORE MOUNTING THE CLUTCH MAKE A COMPLETE INSPECTION OF THE MOTORBIKE COMPONENTS, IN ORDER TO VERIFY THE POSSIBLE PRESENCE OF FAULTS OR ANOMALIES ON THE VEHICLE.
- MAKE SURE THAT THERE ARE NO MISSING/DAMAGED PARTS IN THE CLUTCH KIT
- STM ITALY SRL PRODUCTS ARE EXCLUSIVELY INTENDED FOR COMPETITION ON TRACKS, NOT SUITABLE ON MOTORBIKES ON PUBLIC ROADS.
- SOME PARTS OF THE CLUTCH AND ITS COMPONENTS CAN HAVE SHARP SURFACE: HANDLE WITH CARE.
- SOME COMPONENTS OF THE CLUTCH, BECAUSE OF THEIR SMALL DIMENSIONS CAN BE SWALLOWED: KEEP AWAY FROM CHILDREN.

